

# ELIZABETH COURT

## AN IDAHO CONDOMINIUM PROJECT

LOCATED IN BLOCK 60 OF THE ORIGINAL TOWNSITE OF EAGLE ROCK

First American Title Company

Idaho Falls, Idaho 83404

This sketch is made solely for the purpose of assisting in locating the premises. The company assumes no liability for alleged loss or damage which may result from reliance on this map.



### EXHIBIT "A"

"H" STREET

SAGE AVENUE

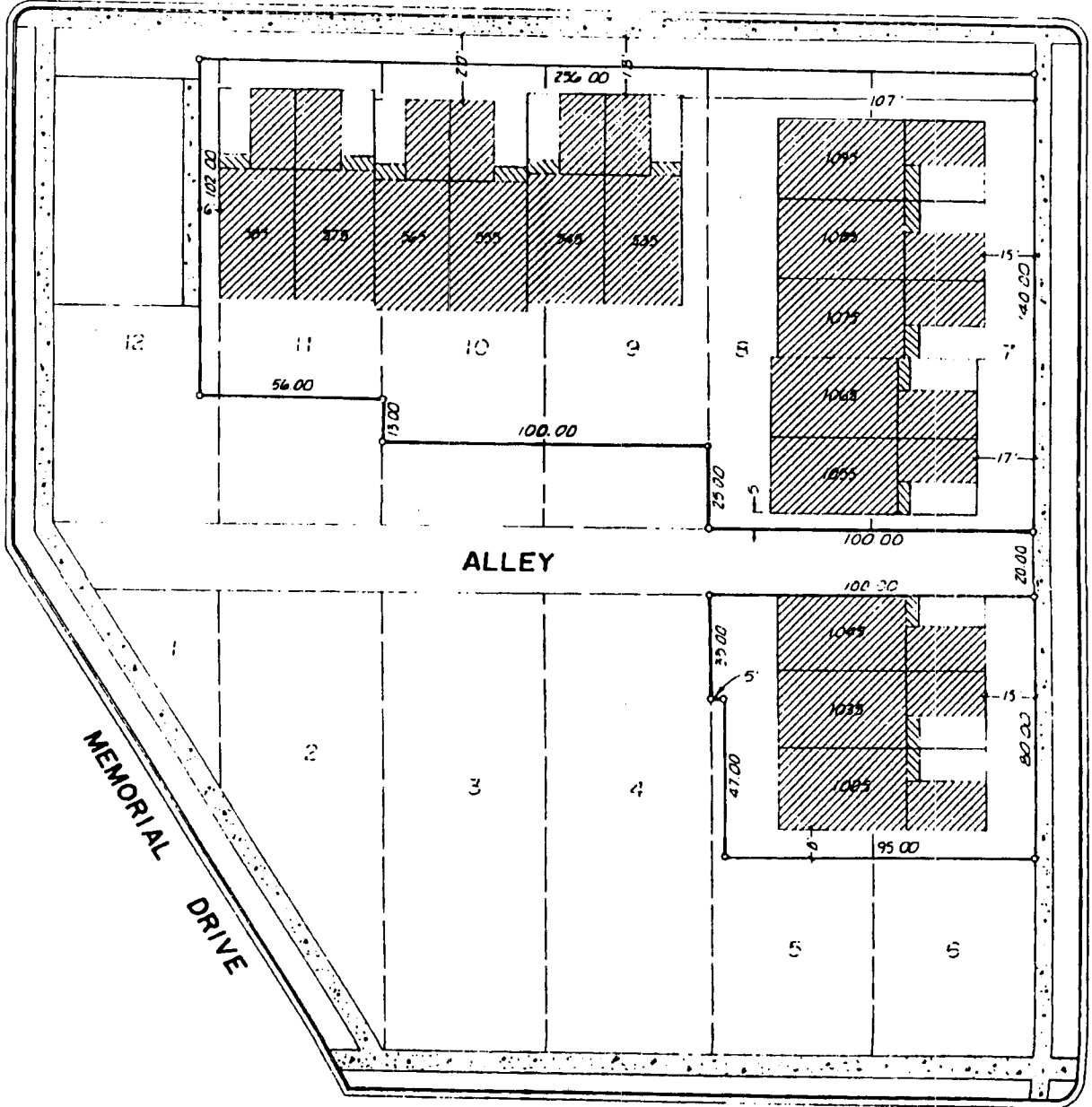

CANAL AVENUE

"G" STREET