

# EXIT 118 EAST

## DIVISION NO. 2

AN ADDITION TO THE CITY OF IDAHO FALLS, BONNEVILLE COUNTY, IDAHO  
 BEING A REPLAT OF EXIT 118 EAST DIVISION NO. 1  
 AND A PORTION OF HOUSTON STREET AND PART OF THE NORTHEAST 1/4 OF  
 SECTION 24, TOWNSHIP 2 NORTH, RANGE 37 EAST, B.M.

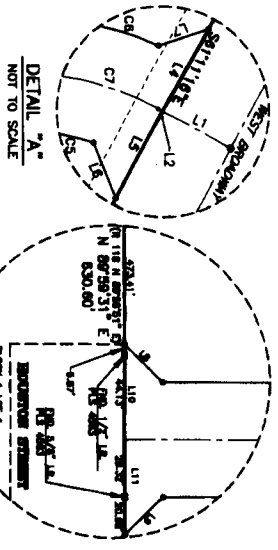

LINE	LENGTH	BEARING
L1	40.00'	N 28° 48' 24\"
L2	2.58'	N 28° 48' 24\"
L3	54.53'	S 61° 11' 16\"
L4	88.67'	S 61° 11' 16\"
L5	51.52'	S 61° 11' 16\"
L6	30.85'	S 68° 48' 04\"
L7	20.34'	S 30° 28' 16\"
L8	28.28'	S 44° 58' 55\"
L9	28.28'	S 44° 58' 55\"
L10	50.00'	N 87° 28' 31\"
L11	50.00'	N 87° 28' 31\"

DETAIL "B"  
 NOT TO SCALE  
 FOUND BRASS CAP  
 CP# 67281190

BASES OF BEARING - CITY OF IDAHO FALLS CONTROL - S 89° 32' 46\"

CURVE DATA  
 A=3709.59'  
 R=1869.86'  
 L=103.33'  
 CD=103.32'  
 CB=S 62° 46' 15\"

- EASEMENTS**
- Idaho Falls Power Easement Instrument No. 1050251
  - Mountain States Telephone and Telegraph Easement Instrument No. 758735
  - Intermountain Gas Company Easement Instrument No. 673731
  - Cross Access Easement Instrument No. 1068074
  - Idaho Falls Power Easement Instrument No. 643788
  - City of Idaho Falls Utility Easement Instrument No. 1981063

### LEGEND

- Section control corners
- Set 5/8\" x 3/8\" iron rod with brass-cap marked P.L.S. 10786
- Set 1/2\" x 2 1/4\" iron rod with brass-cap marked P.L.S. 10786
- Found 5/8\" x 3/8\" iron rod with brass-cap marked P.L.S. 10786
- Found 1/2\" x 2 1/4\" iron rod with brass-cap marked P.L.S. 10786
- Found Highway Right-of-Way Monument Found Brass Cap
- Existing Utility easements are 15' wide unless shown otherwise.
- Public Utility easements are 15' wide unless shown otherwise.
- Record Bearing on Exit 118 East Plat
- Point of Beginning

PROJECT I-G-15-3-(3)117

Curve	Radius	Delta	Length	Chord Bearing	Chord Distance
C1	1065.40'	1° 48' 24\"	272.76'	S 28° 48' 24\"	272.01'
C2	378.00'	5° 48' 24\"	373.01'	N 61° 30' 45\"	387.62'
C3	1869.86'	1° 37' 06\"	52.81'	S 62° 32' 42\"	52.81'
C4	1869.86'	1° 37' 06\"	50.52'	S 61° 57' 42\"	50.52'
C5	120.00'	18° 46' 31\"	39.15'	S 08° 23' 56\"	39.15'
C6	180.00'	23° 46' 31\"	74.80'	S 11° 54' 58\"	74.80'
C7	150.00'	28° 46' 31\"	75.40'	S 16° 24' 42\"	74.81'

CURVE TABLE

BLOCK 1 LOT 1  
 RENAISSANCE CENTER  
 DIVISION NO. 1  
 Three American Title Company  
 Idaho Falls, Idaho 83404  
 While this is a photographic  
 reproduction of the recorded  
 plat, the company assumes no  
 liability for variations,  
 if any, when a re-survey.

