

2ND AMENDED PLAT 17TH STREET MEDICAL PLAZA

AN IDAHO CONDOMINIUM PROJECT
LOCATED IN THE S.E. COR. OF SEC. 21, T.2N., R.38E.B.M.
IDAHO FALLS, IDAHO

Sheet No. **2**
of 2 sheets



First American Title Company

Idaho Falls, Idaho 83404

This sketch is made solely for the purpose of assisting in locating the premises. The company assumes no liability for alleged loss or damage which may result from reliance on this map.

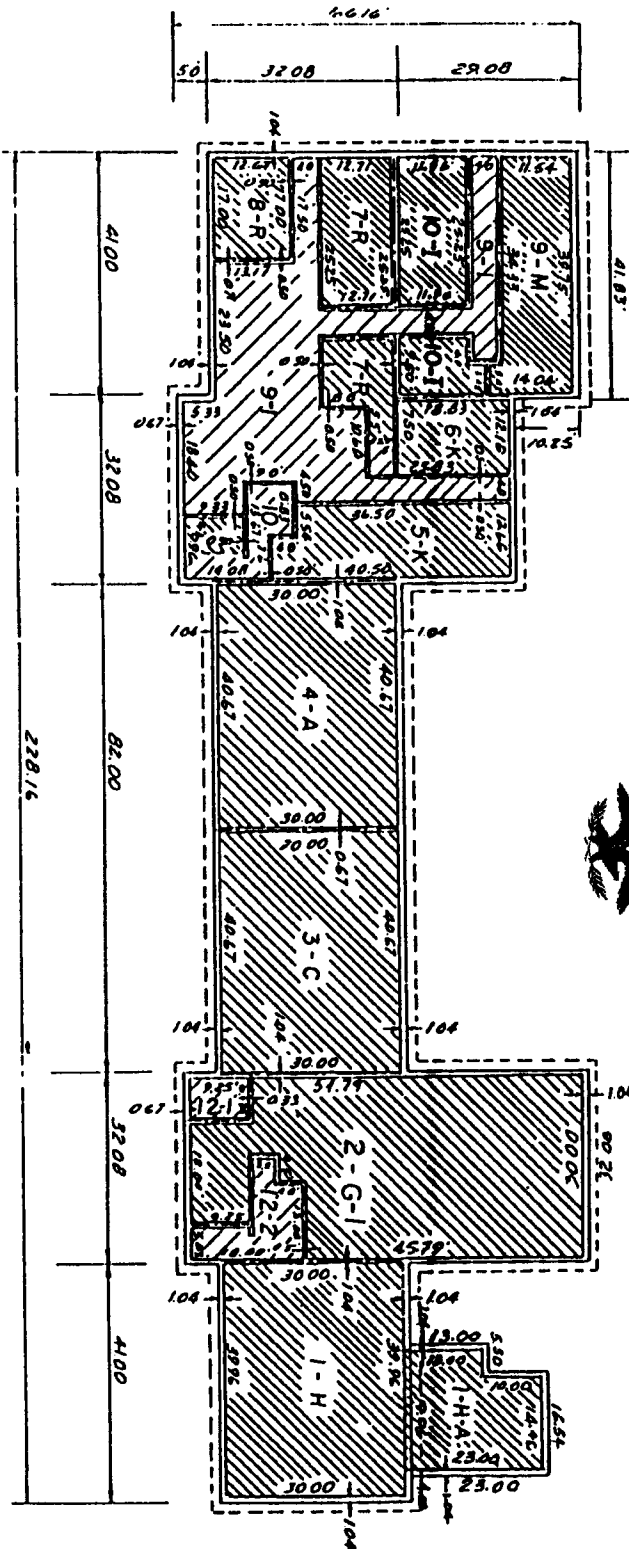

PLAN VIEW

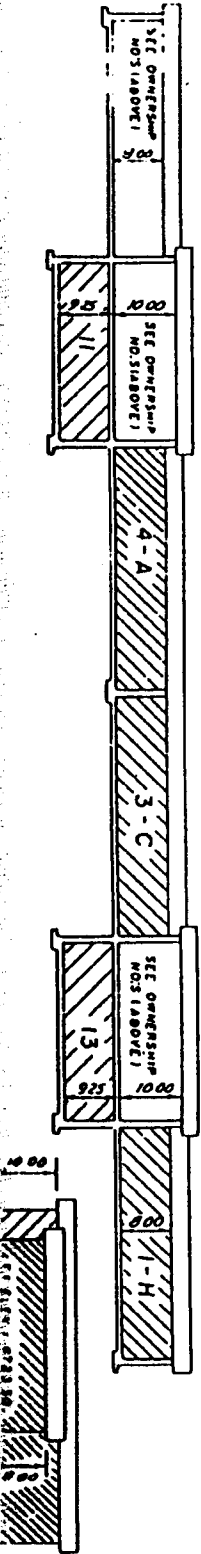

- 1. All interior dimensions are to finished surfaces.
- 2. All elevations shown are sea level base which is also the City of Idaho Falls base.
- 3. Private ownership.
- 4. Limited common use (L.U.) as noted on sheet No. 1.

- 5. Concrete area (see sheet No. 1).
- 6. All areas not cross hatched on sheet No. 1 common use area.
- 7. Wall between units (area is twice to the center line of the wall).