

# SIMMONS HEIGHTS DIVISION NO. 2

## PART OF THE W. 1/2 OF SECTION 8, T. 2 N., R. 39 E., B. M.

BASIS OF BEARINGS  
SECTION LINE ASSUMED NORTH-SOUTH

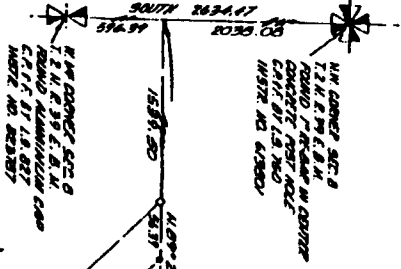

**First American Title Company**  
 Idaho Falls, Idaho 83404

This sketch is made solely for the purpose of assisting in locating the premises. The company assumes no liability for alleged loss or damage which may result from reliance on this map.

- LEGEND & NOTES**
- 1/4" 1.50" Steel Anchor set with plastic cap stamped L.S. 1275
  - 1/2" 1.50" Steel Anchor set with plastic cap stamped L.S. 1275
  - American steel found
  - 1/2" Steel Anchor found with plastic cap stamped L.S. 1275
4. The lot with Utility Easement is hereby granted along of road frontages within each lot.  
 All other easements within are as shown.

THE COUNTY WILL NOT MAINTAIN ROADS UNTIL CONSTRUCTED TO COUNTY STANDARDS AND DIFFICULTLY ACCEPTED. PRIVATE IMPROVEMENT AGREEMENTS WILL BE CONSIDERED AS SHOWN ON IMPROVEMENT DRAWINGS ON FILE IN THE OFFICE OF THE COUNTY ENGINEER AND DRAINAGE SWAKES SHALL BE MAINTAINED.

